

# Technical Lot Plan - Lot 945

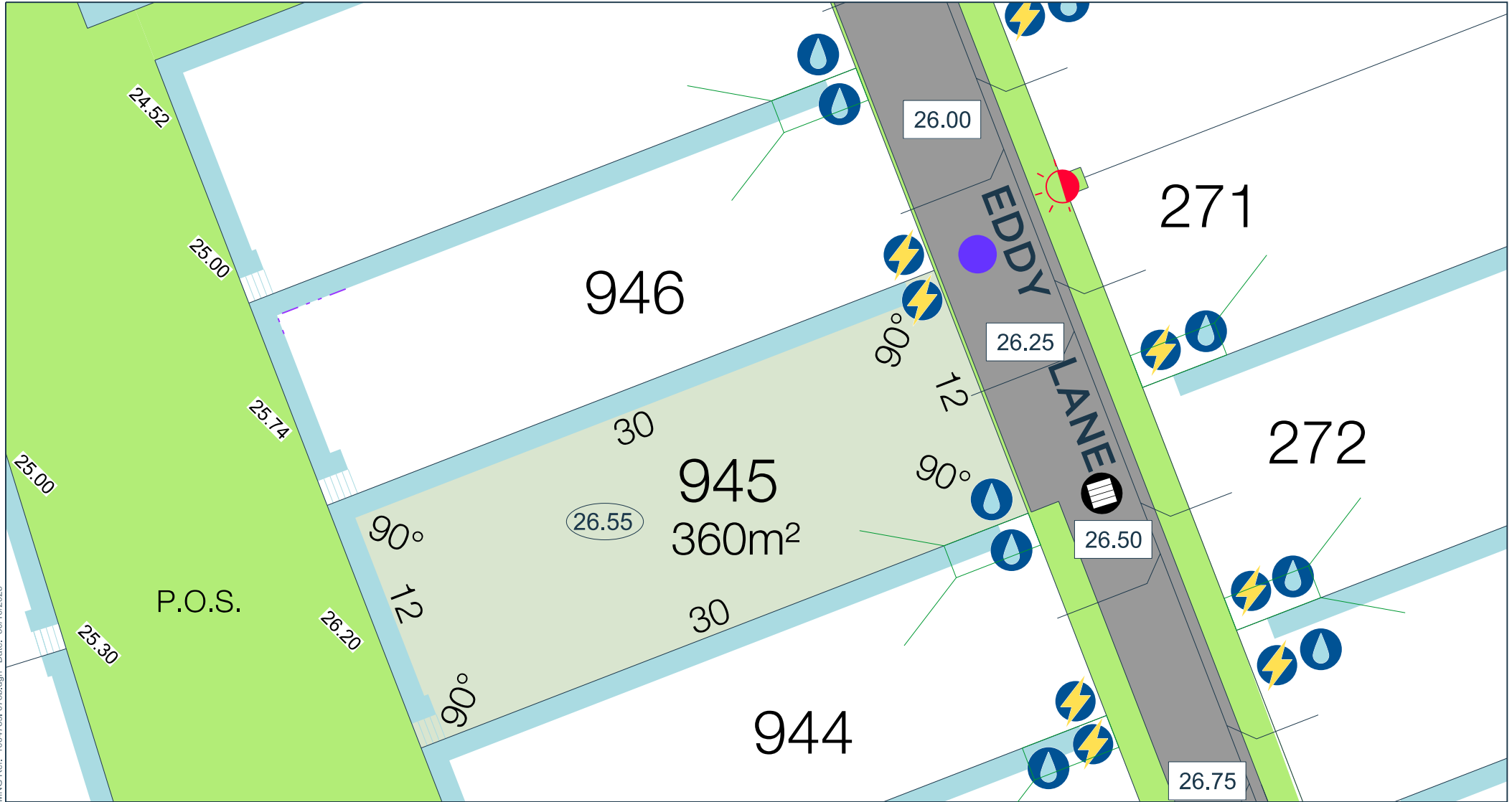

MING Ref: 1004755+078b.dgn Date: 30/10/2023

**LEGEND:**

- |  |  |  |  |  |
|--|--|--|--|--|
|  |  |  |  |  |
|  |  |  |  |  |
|  |  |  |  |  |
|  |  |  |  |  |
|  |  |  |  |  |

Release 5



Scale 1:250



JINDEE

*Where life meets the ocean*

The Statutory Planning controls for this lot are contained in the Individual Lot Plans. All Dimensions and Areas are subject to survey. The particulars on this brochure are supplied for identification purposes only and shall not be taken as a representation in any aspect on the part of the vendor or its agents. Authorities should be consulted when services are contained within lot boundaries as building restrictions may apply. All retaining walls, services and associated easements are shown exaggerated for legibility.