

# Technical Lot Plan - Lot 47

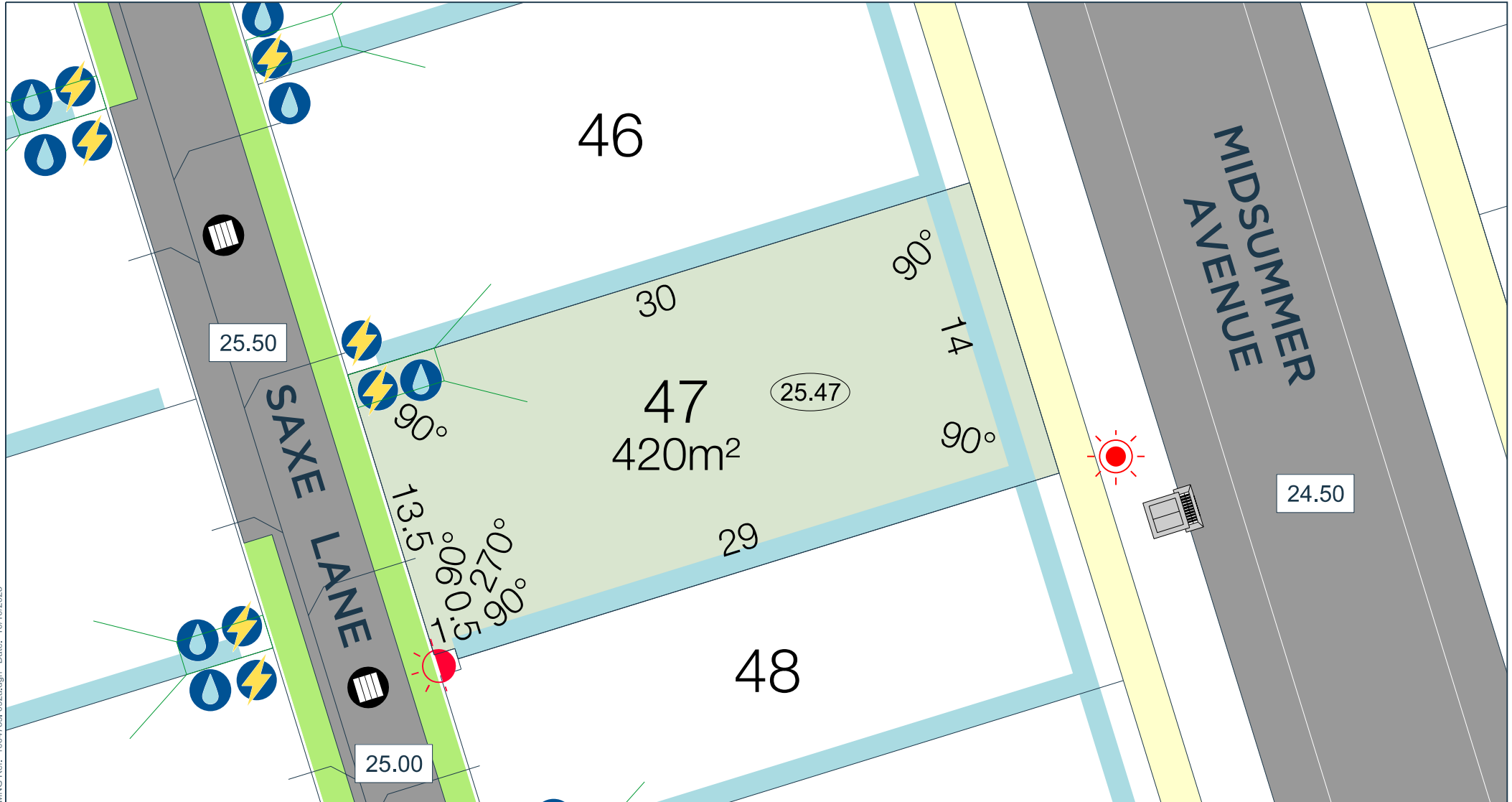

MNG Ref: 1004755-092a.dgn Date: 10/10/2025

### LEGEND:

- |  |   |  |                                |  |                 |  |  |
|--|---|--|--------------------------------|--|-----------------|--|--|
|  | Western Power Housing Connection                  |  | Water Hydrant                  |  | Brick Paving    |  | Retaining walls                                |
|  | Water Connection                                  |  | Water Valve                    |  | Concrete Paving |  | 1.10m High Limestone Fence on Retaining Wall   |
|  | Street Light, Light Pole Easement / Road Widening |  | Road Levels                    |  | Footpaths       |  | 1.10m High Limestone Fence on Concrete Footing |
|  | Sewer Housing Connection/Manhole                  |  | Lot Levels                     |  | Dual Use Paths  |  | Mesh Fencing Panels                            |
|  | Broadband Connection                              |  | Spot Heights                   |  | Bin Pads        |  | 0.6m Picket Fence                              |
|  | Drainage Grate                                    |  | Planter Box Top of Wall Height |  | Planter Pots    |  | Transformer site                               |
|  | Drainage Manhole                                  |  |                                |  |                 |  |  |
|  | Drainage Soakwell                                 |  |                                |  |                 |  |  |
|  | Combination Side Entry Pit                        |  |                                |  |                 |  |  |
|  | Side Entry Pit                                    |  |                                |  |                 |  |  |
|  | Gate  |  |                                |  |                 |  |  |

Release 6A



Scale 1:250



JINDEE

*Where life meets the ocean*

The Statutory Planning controls for this lot are contained in the Individual Lot Plans. All Dimensions and Areas are subject to survey. The particulars on this brochure are supplied for identification purposes only and shall not be taken as a representation in any aspect on the part of the vendor or its agents. Authorities should be consulted when services are contained within lot boundaries as building restrictions may apply. All retaining walls, services and associated easements are shown exaggerated for legibility.